



INTELLIGENT FACILITY SOLUTIONS

Electric Works, 3 Concourse Way, Sheffield, S1 2BJ

United Kingdom: +44 (0) 114 354 0047

Eire: +353 190 36387

sales@ihdryers.co.uk

www.intelligenthanddryers.com

LIQUID SOAP DISPENSERS

SURFACE

Automatic



IFSDJ0160AS-ANON
Satin finish

General Description

- Wall-mounted soap dispenser of 800 ml of capacity, with touchless activation and made of ABS body with a 0.5 mm thick aluminum frame, satin finish.
- The touch free design operates when the built-in infrared smart sensor senses motion under the nozzle and dispenses the liquid.
- Touch-free dispensing prevents cross contamination and germ spread.
- The stylish and functional design of this soap dispenser makes it perfect for any bathroom.
- Transparent plastic content viewer (polycarbonate) on the front.
- Lock with special key to deter theft and vandalism.
- More than 40,000 cycles on six Alkaline AA batteries (not included).
- Flashing LED for battery change.
- Dispenses liquid soaps with neutral pH, free of chlorides. It also accepts disinfectant solutions and hydro alcoholic gel ⁽¹⁾. Viscosity between 500 and 3,500 cP.
- Screws and plastic plugs to mount on a brick wall supplied.

(1) If the alcohol percentage of the soap is higher than 75% it is recommended to change the original silicone tube of the dispenser to the code "RCDJ0160AS-TS" silicone tube, because a high alcohol content (above 75%) can damage the original silicone tube.

Components & materials

- **COVER:** made of black ABS, with hinges that allow swing it for operator convenience and boosting speed of service. Lock located in the upper right side that opens with provided key.
- **COVER FRAME:** made of aluminum, 0.5 mm thick, satin finish.
- **WALL PLATE:** made of ABS. It is mounted on the wall by means of four stainless steel screws (provided) with their corresponding plastic plugs (also provided).
- **INNER PLASTIC TANK:** refillable with a 0.8L capacity and made of Polyethylen. It prevents oxidation and assures an easy removal for cleaning and disinfection purposes.
- **VALVE:** anti-drip and corrosion resistant, made of elastomeric material. It dispenses 1.0 – 2.0 ml of soap per service.
- **POWER:** 6 AA alkaline batteries (not provided).

Technical specifications

Dimensions	<i>118 x 265 x 110 mm</i>
Capacity	<i>0.8 L</i>
Cover frame thickness	<i>0.5 mm</i>
Net weight	<i>0.75 Kg</i>
Quantity dispensed per pump	<i>1.0 - 2.0 ml</i>

Dimensions

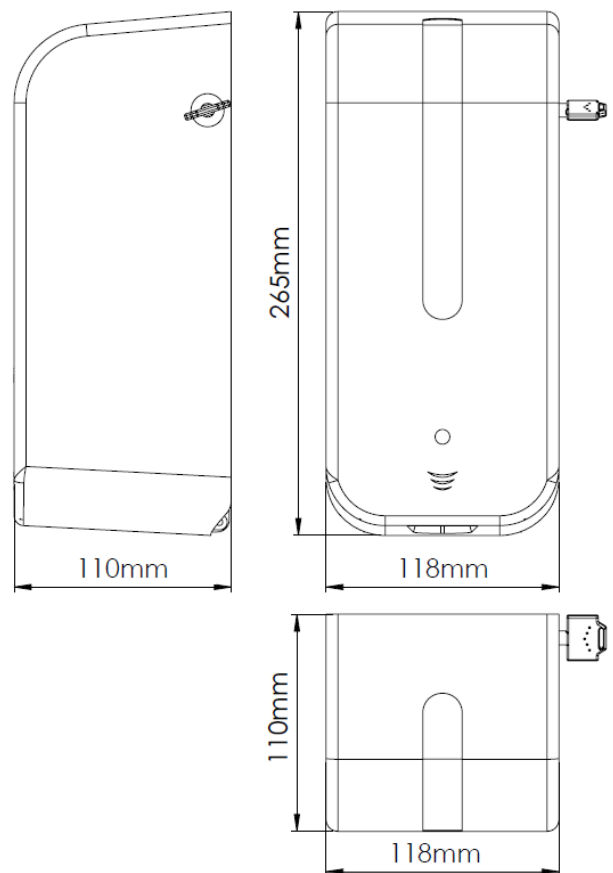

Dimensions: ± 4%

MOUNTING TEMPLATE

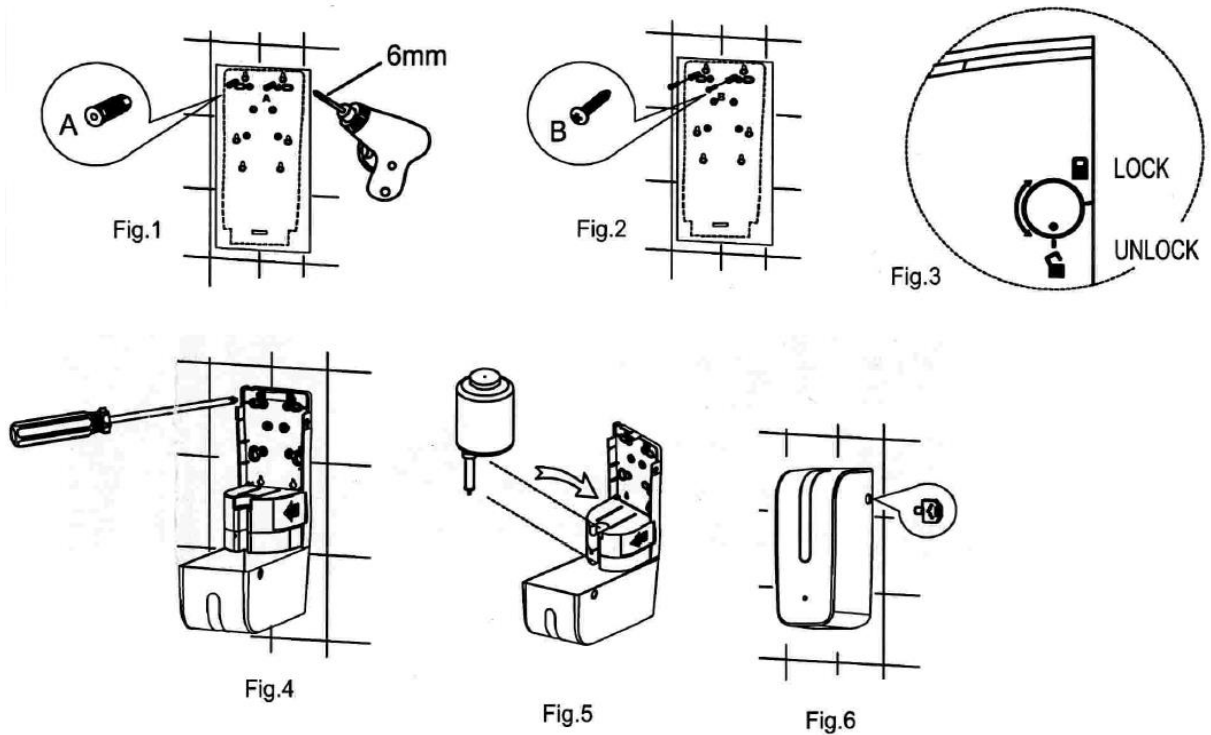

1. Paste the installation template at appropriate location on the wall.
2. Drill two holes dia. $\varnothing 6\text{mm}$, insert plastic dowels . (Fig. 1)
3. Insert two screws into dowels, and partially screw in.
Remove the template. (Fig. 2)
4. USE key to unlock and remove the soap dispenser casing. (Fig. 3)
5. Remove soap tank.
6. Hang soap dispenser onto the screws.
7. Tighten the screws. (Fig. 4)
8. Put soap tank back into housing and close casing. (Fig. 5)
9. Use key to lock casing. (Fig. 6)

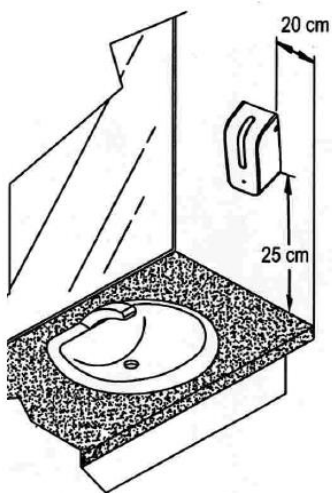

1. Check if surface of wall is smooth and clean.
2. Note the distance between two dispensers or from wall must be $\geq 25\text{cm}$.
3. Make sure there are no obstructions below unit.

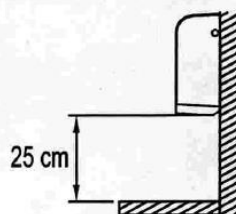

VERY IMPORTANT: do not install this soap dispenser inside the shower, as its electrical components can be seriously damaged by water and the dispenser stops working.